

O-I Manufacturing Italy S.p.A.
 via Washington, 70
 20146 Milano, Italy
 Tel. +39 0243453.1

CONTAINER & MOULD ENGINEERING
EUROPE

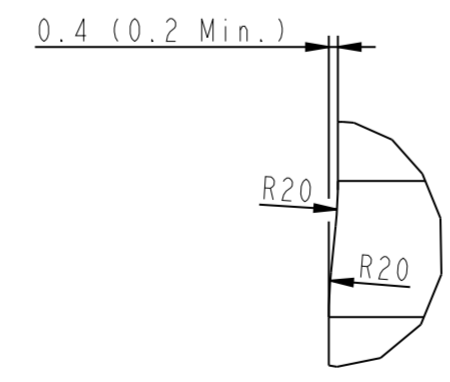
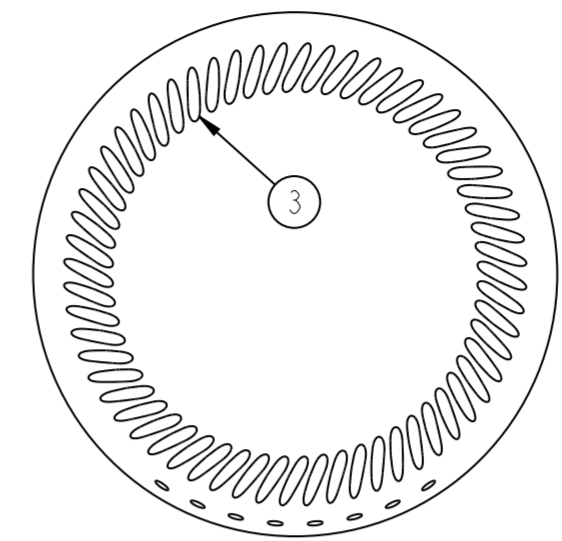
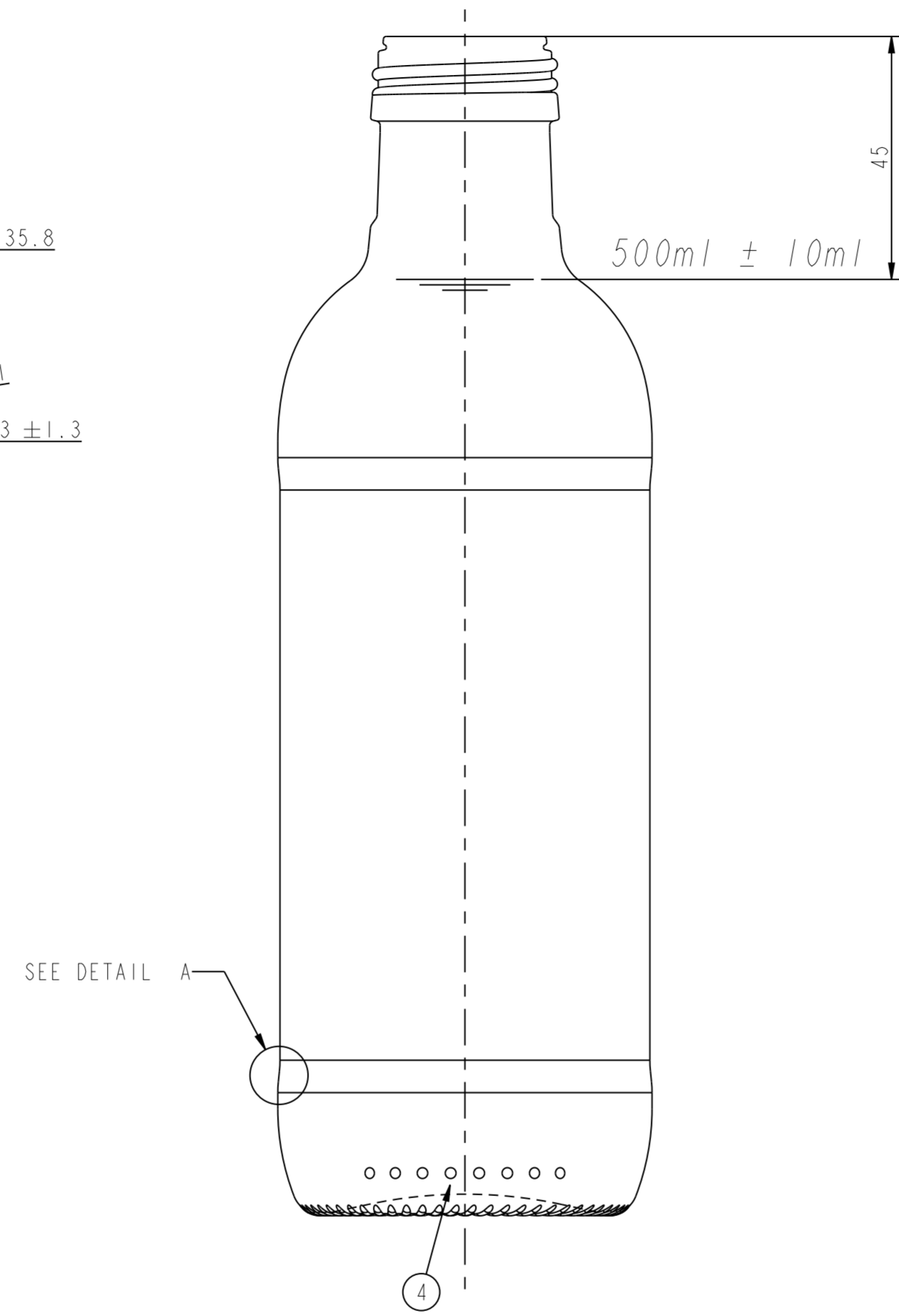
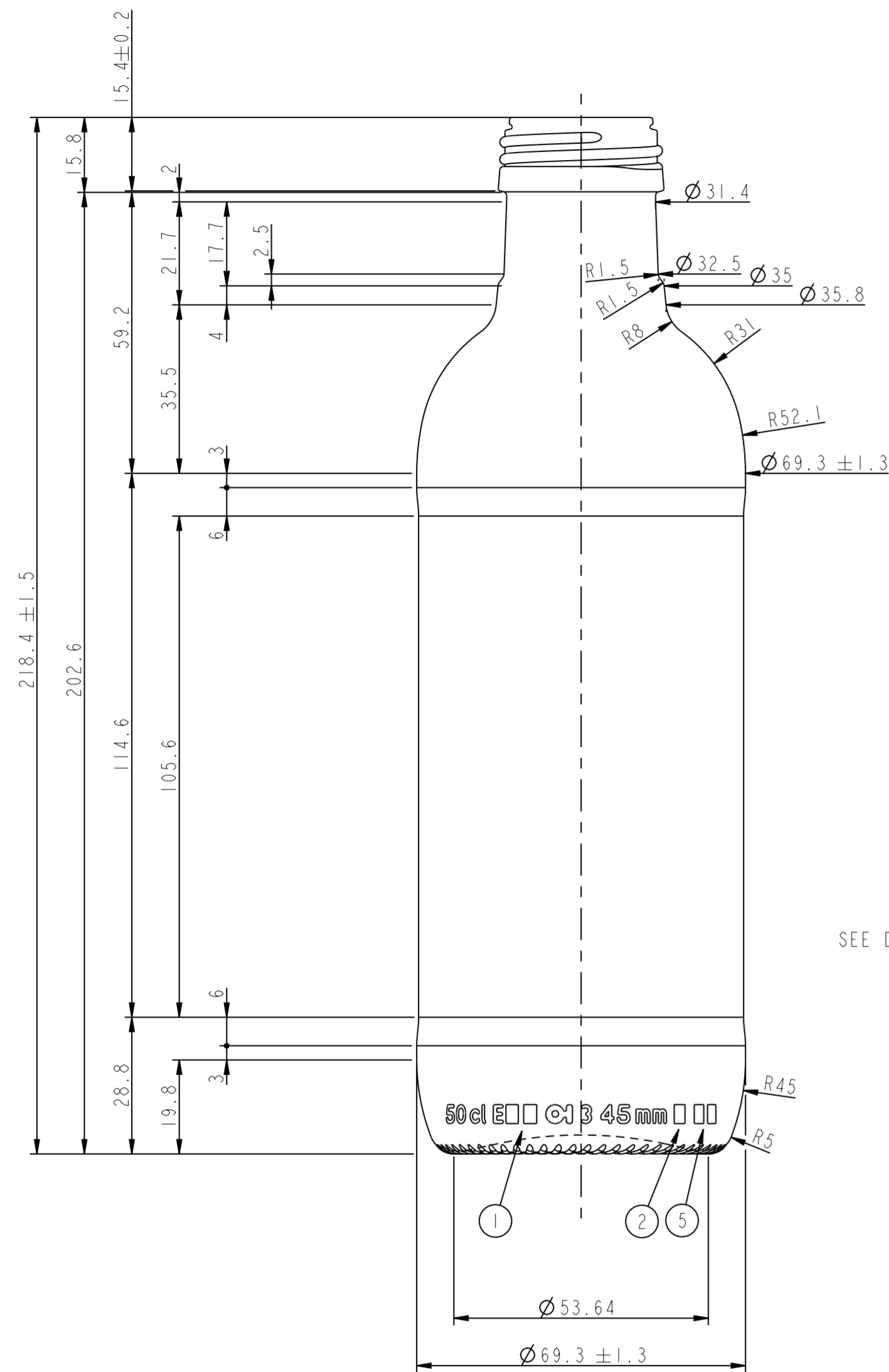

DETAIL A
 SCALE 3/1

NOTES:
 THIS DRAWING IS THE PROPERTY OF O-I AND
 MUST NOT BE REPRODUCED OR DISCLOSED
 WITHOUT O-I WRITTEN AUTHORIZATION.

 ONLY TOLERANCED DIMENSIONS ARE GUARANTEED.

 MANUFACTURING MARKINGS SHOWN ARE FOR ILLUSTRATIVE
 PURPOSES ONLY, ACTUAL MARKINGS ON CONTAINER
 MAY DIFFER, DEPENDANT ON LOCAL LEGISLATION.

1 = TRADEMARK
 2 = CAVITY No.
 3 = STIPPLING
 THE SHAPE OF STIPPLES IS ONLY AN
 INDICATION AND THE CONSTRUCTION IS AT
 THE PRODUCTION PLANT DISCRETION.
 4 = CAVITY CODE
 5 = A GLASS IDENTIFICATION
 6 = KNURLING AT PLANT DISCRETION

SCALE 1:1

CATEGORY FOOD		TILT ANGLE 17.19°	
MAX. VERTICALITY TOLERANCE 2.5 mm		MEASURING CONTAINER YES	
FINISH SAP NUMBER 0847		FINISH REF. UNI 10666 1988	
MINIMUM THROUGH BORE 22.0 mm		MAX FILLING TUBE Ø 20.5 mm	
CONTAINER OVERFLOW CAPACITY (BRIMFUL)			
525ml APPROX.			
CONTAINER RATED CAPACITY (FILLPOINT)			
500ml ± 10ml			
CONTAINER WEIGHT			
300g APPROX.			
FINISH DESIGNATION IT_35_UNI 10666_H158_0847		MAX GAS VOLUME	
PROCESS NO	RETURNABLE NO	DESIGN REF.	
STANDARD			
50cl New Olio Extra			
DESIGNER	NS	DATE	15.09.09
CHECKED		DATE	
DRAWING NUMBER 090637		MOULD/SAP NUMBER 008222	

No	DATE	REVISIONS	DESIGN/CHECK
2	09.04.10	ADDED SAP NUMBER - CHANGED MINIMUM THROUGH BORE	CM
1	21/09/09	MODIFIED SHOULDER GEOMETRY	GP